





LB SERIES

CONDUIT BODIES



INCLUDES:

-  x 2 cover screws
-  set screws for EMT
-  x 1 neoprene gasket
-  x 1 stamped aluminum cover



CONSTRUCTION

- Die cast aluminum combination fitting (EMT and rigid) available in 1/2", 3/4", 1", 1-1/4", 1-1/2", 1-3/4" and 2" sizes.
- Unit is threaded for rigid conduit and has set screws for EMT.
- Separate fittings for EMT and rigid available in larger sizes of 2-1/2", 3", 3-1/2" and 4".
- Durable grey powder coat paint finish.

FEATURES

- Product includes conduit body, black neoprene gasket, stamped aluminum cover with screws.

APPLICATION:

-  Ideal for industrial or commercial use
-  Weather resistant

CERTIFICATION:



DIMENSIONS

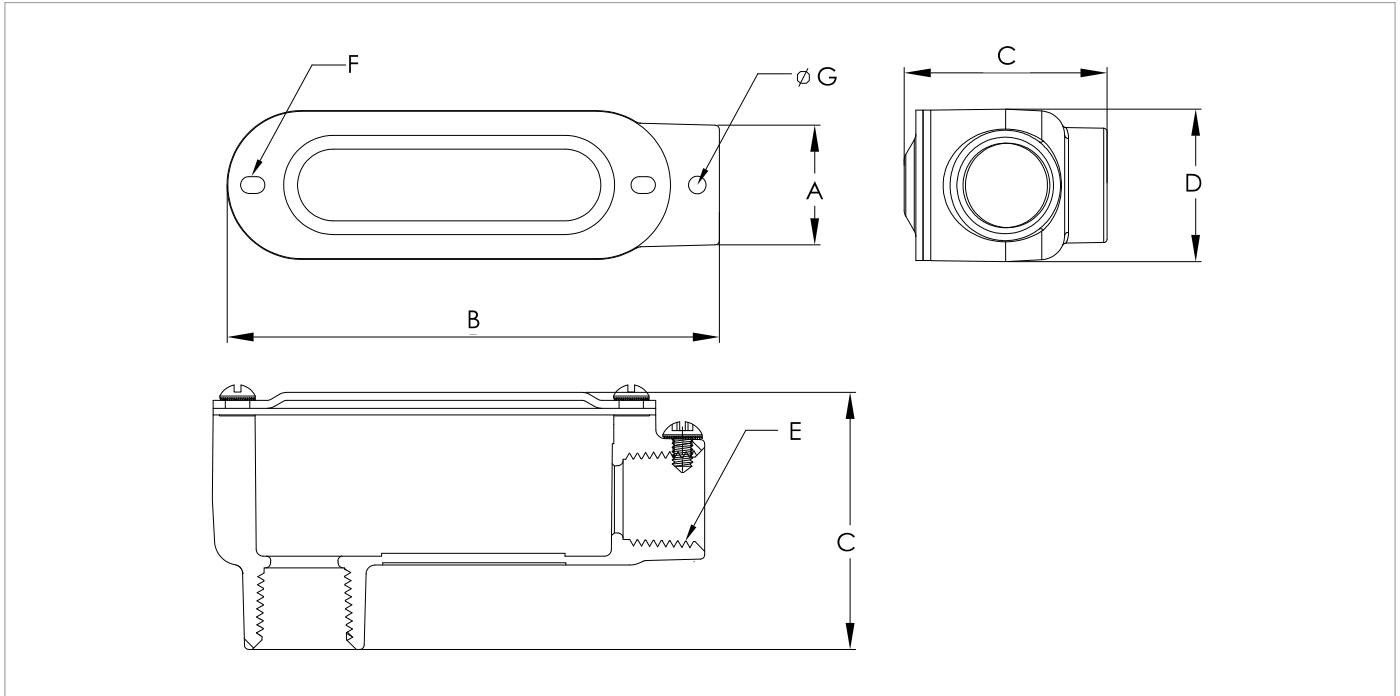

PRODUCT	A	B	C	D	E CONDUIT SIZE	F COVER SCREWS	G SET SCREWS
LB-50-CG CONDUIT BODY	1.06	4.37	2.30	1.31	1/2"	2x8-32	2x10-24
LB-75-CG CONDUIT BODY	1.31	5.12	2.56	1.53	3/4"	2x8-32	2x10-24
LB-100-CG CONDUIT BODY	1.54	5.88	2.85	1.78	1"	2x8-32	2x10-24
LB-125-CG CONDUIT BODY	1.91	7.68	3.63	2.50	1-1/4"	2x12-24	4x1/4-20
LB-150-CG CONDUIT BODY	2.19	7.68	3.79	2.50	1-1/2"	2x12-24	4x1/4-20
LB-200-CG CONDUIT BODY	2.60	10.02	4.56	3.13	2"	2x12-24	4x1/4-20
LB-250-CG CONDUIT BODY	3.35	12.71	5.38	4.41	2-1/2"	2x5/16-18	4x5/16-18
LB-300-CG CONDUIT BODY	3.98	12.72	5.95	4.41	3"	2x5/16-18	4x5/16-18
LB-350-CG CONDUIT BODY	4.96	15.55	7.29	5.47	3 1/2"	2x5/16-18	4x5/16-18
LB-400-CG CONDUIT BODY	4.96	15.55	7.29	5.47	4"	2x5/16-18	4x5/16-18

ORDER INFO

STOCK CODE / DESCRIPTION	STOCK CODE / DESCRIPTION
008779 LB-50-CG CONDUIT BODY	008893 LB-250-CG RIGID CONDUIT BODY
008780 LB-75-CG CONDUIT BODY	008854 LB-300-CG EMT CONDUIT BODY
008781 LB-100-CG CONDUIT BODY	008894 LB-300-CG RIGID CONDUIT BODY
008782 LB-125-CG CONDUIT BODY	008903 LB-350-CG RIGID CONDUIT BODY
008783 LB-150-CG CONDUIT BODY	008855 LB-400-CG EMT CONDUIT BODY
008784 LB-200-CG CONDUIT BODY	008895 LB-400-CG RIGID CONDUIT BODY
008853 LB-250-CG EMT CONDUIT BODY	