

INSTALLATION INSTRUCTIONS



ELECTRICAL SHOCK HAZARD

READ, UNDERSTAND, and FOLLOW these instructions before installing the equipment.

WARNING

Disconnect the Electrical supply power at the service panel (fuse or circuit breaker box). Failure to do so could result in serious injury or death. Only qualified electricians should install this fixture and the installation MUST conform to the Canadian Electrical Code Part I and all local codes and ordinances. Ensure that only proper tools, materials, and equipment are used to complete the installation.

SAFETY

- Proper grounding is required to ensure personal safety.
- Fixture should be mounted in locations where unauthorized personnel will not readily subject it to tampering.
- Do not use this equipment for anything other than its intended purpose.
- Servicing this equipment should be performed by qualified service personnel.
- Save these instructions.
- **MIN 90 °C SUPPLY CONDUCTOR**

INSTALLATION:

- The wire connections are accessible by opening the access plate with a screwdriver.

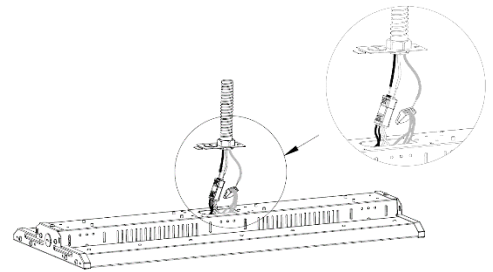

Suspended Mount:

- 1) Connect the chain with fixture using V-hooks.
- 2) Fix the chain to the ceiling and adjust the chain length as desired.
- 3) After fixing, choose suitable wiring knock out and make wiring connections as per wiring diagram.

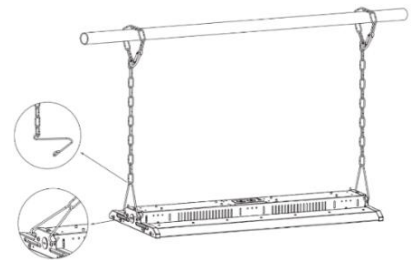

Pendent Mount:

(Battery Backup cannot be chosen with this mount)

- 1) Mount the bracket on pendant pipe.
- 2) Lock fixture onto the bracket and secure with screws.
- 3) After fixing, choose suitable wiring knock out and make wiring connections as per wiring diagram
- 4) Install side plates and secure with screwdriver.

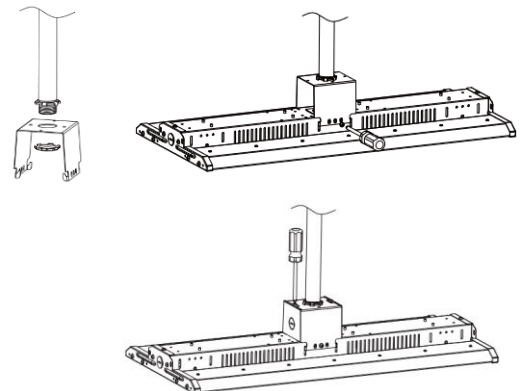

INSTALLATION INSTRUCTIONS**Surface Mounting:**

- 1) Mount the bracket on the rail or ceiling.
- 2) Mount the fixture bracket on the bolt and then install the fixture.
- 3) After mounting, choose suitable wiring knock out and make wiring connections as per wiring diagram.

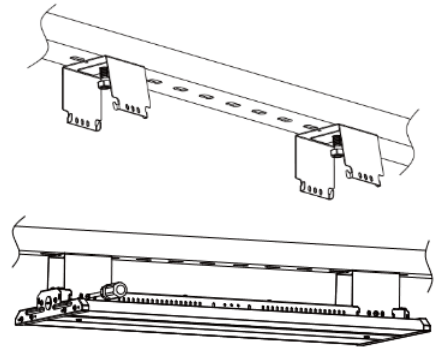
**Extra Accessory Option Installation:****Wire Guard:**

- 1) Mount the wire guard on the fixture and secure with screws.

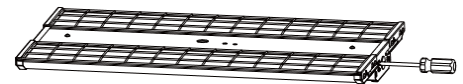
**DC Motion Sensor:**

- 1) Use a screwdriver to remove the plug from the sensor receptacle.
- 2) Twist-lock the DC sensor onto the receptacle and use a remote control to adjust the settings.

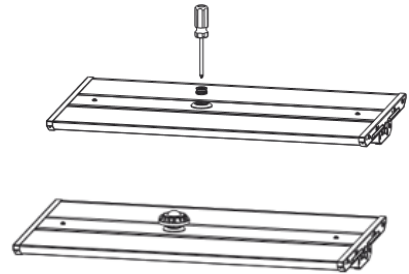
**CCT Tunable (If Applicable)**

CCT selectable switch is included in every luminaire. It is accessed outside during installation. The switch can be set to 4000K, and 5000K CCT.

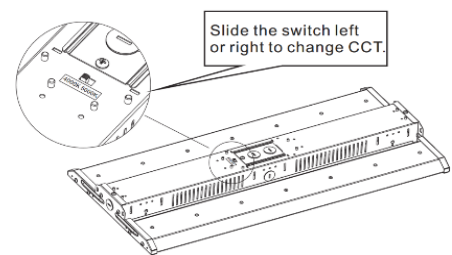
**WIRING**

- Check that the line voltage is correct.
- Connect fixture **GROUND** (green) wire to power supply **GROUND** (green) wire.
- Connect fixture **WHITE** wire to power supply **NEUTRAL** wire.
- Connect fixture **BLACK** wire to power supply **LINE** wire
- The fixture includes 0-10V dimming functionality, connect **GREY** or **PINK** and **VIOLET** wires to a 0-10V dimming controller or motion sensor (optional).

